

LED Driver

High Power Constant Current LED Driver Wall-mount and Hook-up Wire

Total Power	12.6 Watts max.
Input Voltages	100-250 VAC
Number of Outputs	One

Product Specifications

ANZ#: 128d ,October 31, 2009

SPECIAL FEATURES

- Compact size that maximize design flexibility.
- 2.56" x 1.38" x 0.90" (LxWxH)
- Full range AC input
- Available in Wall-mount and hookup wire style
- High efficiency reduce total power consumption
- Tight regulated constant current output to maximize the LED performance
- Pre-adjusted C/C outputs

ELECTRICAL SPECIFICATIONS

Input range	100 to 250 VAC, Full range
Frequency	47 to 63 Hz
Inrush current	30.0 Amps maximum at any input range
Input current	0.3Amps maximum at 115/230 input range
Efficiency	65% typical at 120VAC and maximum load
EMI filtering	FCC part 15J class B, CISPR 22 class B
Maximum power	12W
Output regulation	±5% @constant current mode
Hold up time	10ms minimum at 120 VAC and 80% of rated load
Protection	Overload protection, Short Circuit Protection

ENVIRONMENTAL

Operating temperature:	-20 to+60 ° C
Storage temperature:	-20 to 80 ° C
Humidity (Non-Condensing):	5% to 95%
Cooling:	Convection
Vibration Frequency:	5 to 55 Hz
MTBF:	>100,000 Hours at full load and 25°C ambient conditions (MIL-217E)

SAFETY

UL, cUL and CE certified

ORDERING INFORMATION

Model #	Output Voltage Range (VDC)	Output Current (mA)	Output Power (W)
LD-CU3503AF	4 ~ 12V	350mA	4.2-Watts
LD-CU3536AF	4 ~ 28V	350mA	10-Watts
LD-CU7006AF	4 ~ 12V	700mA	6.5-Watts
LD-CU7021AF	4 ~ 18V	700mA	12.6-Watts
LD-PI3503AF	4 ~ 12V	350mA	4.2-Watts
LD-PI3536AF	4 ~ 28V	350mA	10-Watts
LD-PI7006AF	4 ~ 12V	700mA	6.5-Watts
LD-PI7021AF	4 ~ 18V	700mA	12.6-Watts

MECHANICAL DRAWINGS

LD-XX = Enclose type
CU = Hook up wire style
PI = Wall-mount style

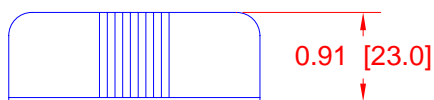
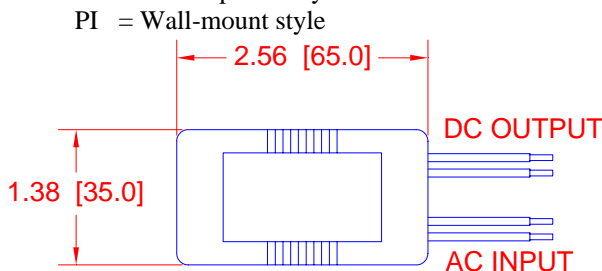

LD-CU Series

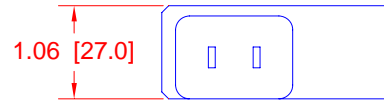
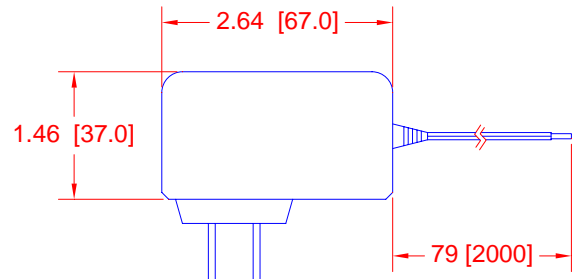

LD-PI Series

