



CFM100M SERIES

100W MEDICAL OPEN FRAME AC-DC MODULES WITH PFC



Features

- * Universal Input RANGE 90-264VAC
- * Medical and ITE Safeties
- * 3"x 5" Compact Size
- * Less than 1U high
- * Industry Standard Pin Out
- * High Efficiency up to 90%
- * Meets CISPR/FCC Class B
- * Remote Voltage Sense
- * Over Voltage Protection
- * Continuous Short Circuit Protection
- * No load Power Consumption<0.5W



"Go to www.cincon.com for additional technical information"

MODEL	OUTPUT VOLTAGE	MAX. LOAD	MIN. LOAD	RIPPLE & NOISE	VOLTAGE ACCURACY	LINE REGULATION	LOAD REGULATION	% EFF.
CFM100M050	5V	20A	0A	2%	±1%	±0.5%	±1%	86% Typ.
CFM100M090	9V	11.2A	0A	1%	±1%	±0.5%	±1%	88% Typ.
CFM100M120	12V	8.4A	0A	1%	±1%	±0.5%	±1%	89% Typ.
CFM100M150	15V	6.7A	0A	1%	±1%	±0.5%	±1%	89% Typ.
CFM100M180	18V	5.6A	0A	1%	±1%	±0.5%	±1%	90% Typ.
CFM100M240	24V	4.2A	0A	1%	±1%	±0.5%	±1%	91% Typ.
CFM100M480	48V	2.1A	0A	1%	±1%	±0.5%	±1%	91% Typ.

Specifications

INPUT SPECIFICATIONS:

Voltage	90~264Vac
Frequency	47 to 63Hz
Inrush Current	80A max. @240Vac
Conducted EMI	CISPR/FCC Class B
Isolation	Input to output = 5,656VDC
Leakage Current	300uA max.

OUTPUT SPECIFICATIONS:

Holdup Time	16ms typ.
Short Circuit Protection	Continuous
Over Voltage Protection	Recycle AC input to restart

ENVIRONMENTAL CHARACTERISTICS:

Operating Temperature	0 ~ 40°C
Storage Temperature	-20 ~ 85°C
Cooling	Natural Convection

MECHANICAL CHARACTERISTICS:

Dimensions	5.000x3.000x1.000inches (127.00x76.20x25.40mm)
Weight	385g (0.85Pounds)

CFM100M Series Derating Curve

CFM100M050/090

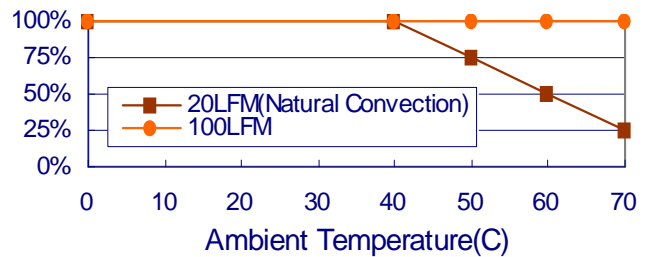

Others

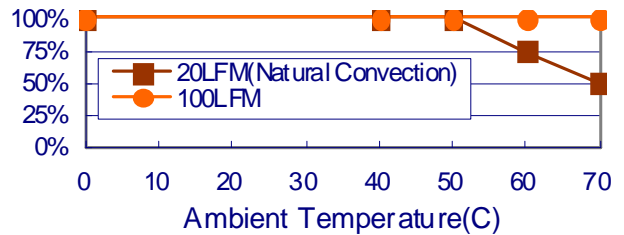

NOTE:

1. CFM100M05/090/120: Add a 0.1uF ceramic capacitor and 220uF E.L. capacitor to output for Ripple & Noise measuring @20MHz BW.
Other Model: Add a 0.1uF ceramic capacitor and a 10uF E.L. capacitor to output for Ripple & Noise measuring @20MHz BW.
2. Line regulation is measured from High Line to Low Line with full load.
3. Load regulation is measured from Full to 10% load.
4. Dimensions tolerance: +/-1 mm
5. Connectors: AC input: Molex 5227 or equivalent
DC output: Molex 5273 or equivalent
6. DC output pin 1,2,3,4: Vout (+), DC output pin 5,6,7,8: Vout (-)

CFM100M Series

All Dimensions are in inches[mm]
Tolerance: Inches:x.xxx= ±0.02
Millimeters:x.xx= ±0.5

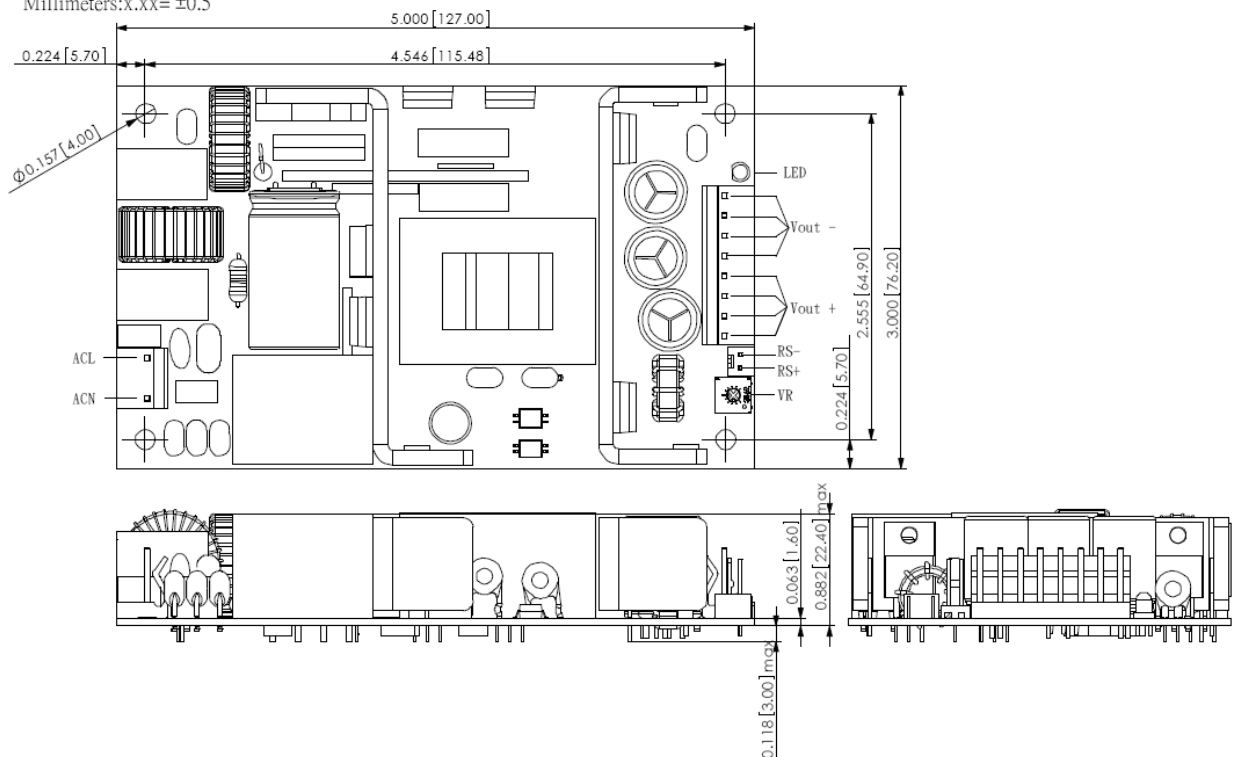

Typical at 25°C, nominal line and 75% load, unless otherwise Specified

Revision History

Revision Version	Date	Change Description	Signature
V10	98.09.02	New Release	Kidd

